

# St. John's Episcopal Church Schools Retreat Center

By:

**Dr. Cyril E. Broderick, Sr. &  
Mr. William F. Sherman**

# INTRODUCTION

- We have an opportunity:
  - The Government of Liberia under the leadership of President William V. S. Tubman, in 1959, granted the St. Johns Episcopal Schools in Grand Cape Mount County a parcel of land of five hundred (500) acres, as described in the report secured by Mr. William F. Sherman for the Association.
  - The land is ours.
- Here are some recommendations in terms of (1) Short Range, Medium Range, and Long Range plans:
  - It is important to note here that our time for follow-up is limited.
  - We have to act now.

# The Land Promised

- Per the description depicted, the schematic representation of the site and a proposal as to how we can proceed follow.

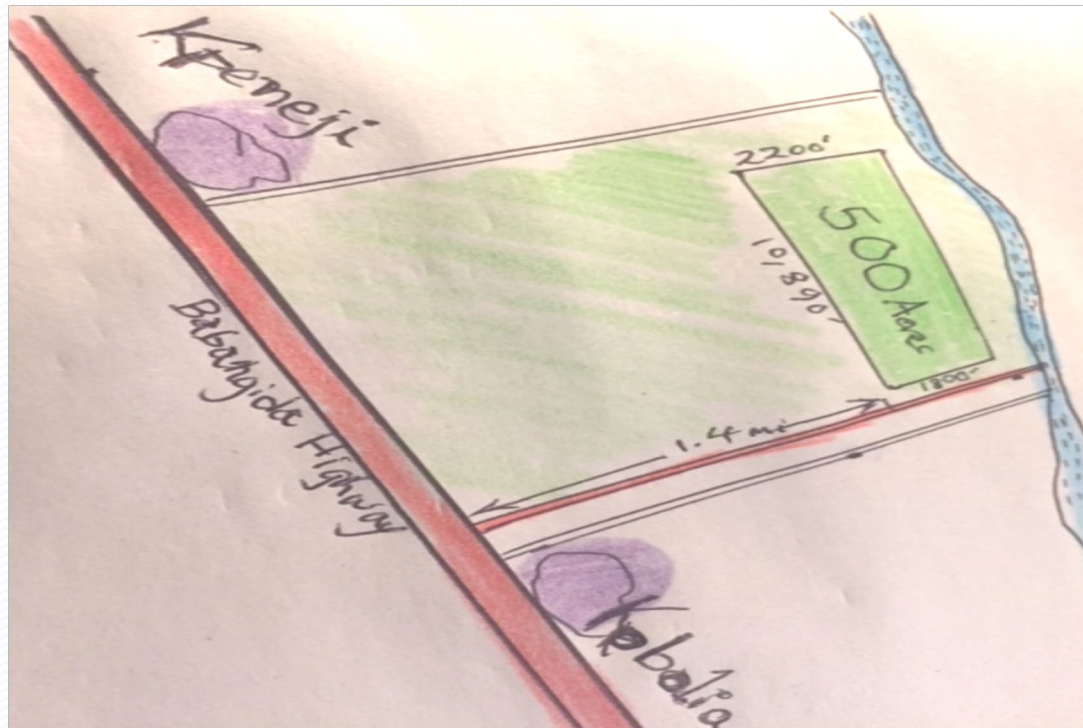

# Firstly, there is the urgent need to survey the land.

- Surveying the land would provide longitudinal and latitudinal coordinates, as well as distance measures to assure the physical localization of the said parcel.
- A deed would be created and deposited in the Archives of the Republic of Liberia to designate the land as the possession of the St. John's Episcopal Schools.
- The land would be accessed and utilized to produce commensurate income for the schools.

# Time-table and Planning

- There are three terms in the time-table, namely:
  - A. A short-range start that should be completed in the next year or two;
  - B. A medium range follow-through that goes through the fifth year; and
  - C. A long-range plan that extends from the five-year period through the tenth year and beyond.

# Short-Term Plan

- 1. Survey the land.
- 2. Employ a caretaker.
- 3. Build a small residence for the caretaker.
- 4. Establish a vegetable garden.
- 5. Establish a piggery for 10 sows, 2 boars and their offspring (piglets)
- 6. Other miscellaneous plans can be set in place, including raising goats and sheep, installing a water pump, training people in application of solar radiation projects, and so many other similar project efforts can begin to be designed.

# Medium-Term Plan

- Build a hostel and promote summer programs.
- Committees between the Alumni Association here, the Alumni in Liberia, as well as students, faculty and clergy, can all develop and execute a variety of programs, i. e., from driver's education to playing musical instruments.
- Expand the production and marketing of crops from plant and animal production, as well as crafts production, from the Center.

# Long-Term Plan

- Animal Farms & Cattle Ranch
  - Poultry and eggs, pork, beef, and even mutton production would be pursued.
- Cocoa farm
  - It takes three to six years to get into production, but it can be very profitable.
- Coffee farm
  - Arabica coffee is the best priced and most widely marketed. Robusta is second. Liberica is also a good coffee, but the market has to be further developed.
- Oil palm farm
  - Production can be enormous after a few years, and marketing can be local or through the Guthrie Plantations facilities.



# Discussion

- Income secured from the Center would support the school and its programs.
- Income potentials are high, and can be managed through volunteers and employees, per guidance of the Association.
- A suggested pattern is:

• Year	Income (US\$/year)
• 2019	5,000.00
• 2020	10,000.00
• 2021 to 2025	20,000.00
• Beyond 2025	50,000.00+++

# CONCLUSION

- The opportunity is ours, we must seize it.
- The essence, as similarly said in Shakespeare, is:
- There are tides in the affairs of men, which taken at their flood, lead onto fortune; omitted all the days of your life are bound in shallows and in misery. On such a tide are we now afloat.